

# ANSI B16.5 Class 400 Weld-Neck Flanges

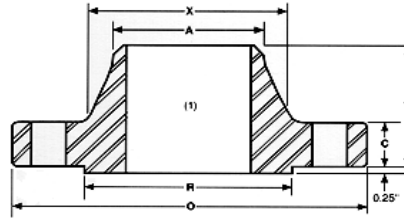

| Nominal Size | Outside Diameter O | Thickness C | Dia Of Raised Face R | Dia. Of Hub At Base X | Dia. Of Hub at welding Point A | Length Thru Hub Y | No. Of Holes | Dia. of holes | Dia. Of Bolts | Dia. Of Bolt Circle | Approx. Weight (Lbs) |
|--------------|--------------------|-------------|----------------------|-----------------------|--------------------------------|-------------------|--------------|---------------|---------------|---------------------|----------------------|
| 1/2"         | 3.50               | 0.44        | 1.38                 | 1.19                  | 0.84                           | 1.88              | 4            | 0.62          | 1/2           | 2.38                | 2                    |
| 3/4"         | 3.88               | 0.50        | 1.69                 | 1.50                  | 1.05                           | 2.06              | 4            | 0.62          | 1/2           | 2.75                | 2                    |
| 1"           | 4.25               | 0.56        | 2.00                 | 1.94                  | 1.32                           | 2.19              | 4            | 0.62          | 1/2           | 3.12                | 3                    |
| 1 1/4"       | 4.62               | 0.62        | 2.50                 | 2.31                  | 1.66                           | 2.25              | 4            | 0.62          | 1/2           | 3.50                | 3                    |
| 1 1/2"       | 5.00               | 0.69        | 2.88                 | 2.56                  | 1.90                           | 2.44              | 4            | 0.62          | 1/2           | 3.88                | 4                    |
| 2"           | 6.00               | 0.75        | 3.62                 | 3.06                  | 2.38                           | 2.50              | 4            | 0.75          | 5/8           | 4.75                | 6                    |
| 2 1/2"       | 7.00               | 0.88        | 4.12                 | 3.56                  | 2.88                           | 2.75              | 4            | 0.75          | 5/8           | 5.50                | 8                    |
| 3"           | 7.50               | 0.94        | 5.00                 | 4.25                  | 3.50                           | 2.75              | 4            | 0.75          | 5/8           | 6.00                | 10                   |
| 3 1/2"       | 8.50               | 0.94        | 5.50                 | 4.81                  | 4.00                           | 2.81              | 8            | 0.75          | 5/8           | 7.00                | 12                   |
| 4"           | 10.00              | 1.38        | 6.19                 | 5.75                  | 4.50                           | 3.50              | 8            | 1.00          | 7/8           | 7.88                | 35                   |
| 5"           | 11.00              | 1.50        | 7.31                 | 7.00                  | 5.56                           | 4.00              | 8            | 1.00          | 7/8           | 9.25                | 43                   |
| 6"           | 12.50              | 1.62        | 8.50                 | 8.12                  | 6.63                           | 4.06              | 12           | 1.00          | 7/8           | 10.62               | 57                   |
| 8"           | 15.00              | 1.88        | 10.62                | 10.25                 | 8.63                           | 4.62              | 12           | 1.12          | 1             | 13.00               | 89                   |
| 10"          | 17.50              | 2.12        | 12.75                | 12.62                 | 10.75                          | 4.88              | 16           | 1.25          | 1 1/8         | 15.25               | 125                  |
| 12"          | 20.50              | 2.25        | 15.00                | 14.75                 | 12.75                          | 5.38              | 16           | 1.38          | 1 1/4         | 17.75               | 175                  |
| 14"          | 23.00              | 2.38        | 16.25                | 16.75                 | 14.00                          | 5.88              | 20           | 1.38          | 1 1/4         | 20.25               | 230                  |
| 16"          | 25.50              | 2.50        | 18.50                | 19.00                 | 16.00                          | 6.00              | 20           | 1.50          | 1 3/8         | 22.50               | 295                  |
| 18"          | 28.00              | 2.62        | 21.00                | 21.00                 | 18.00                          | 6.50              | 24           | 1.50          | 1 3/8         | 24.75               | 350                  |
| 20"          | 30.50              | 2.75        | 23.00                | 23.12                 | 20.00                          | 6.62              | 24           | 1.62          | 1 1/2         | 27.00               | 425                  |
| 24"          | 36.00              | 3.00        | 27.25                | 27.62                 | 24.00                          | 6.88              | 24           | 1.88          | 1 3/4         | 32.00               | 620                  |

**Sumitec Int'l, Inc**

Phone (877)-837-9618 Fax (866) 311-5335 email:sumitecsales@comcast.net

**We also Supply Carbon and Stainless Steel Buttweld Fittings and Pipes**