

INDUSTRY STANDARD CLASS 175 WN SLIP-ON & BLIND FLANGES

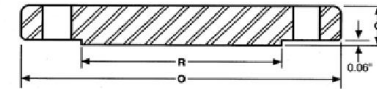
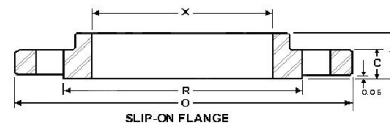
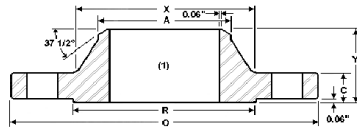

Nominal Size	Outside Diameter	Thickness			Diameter Raised face	Hub Diameter	Bore Slip-On	Length Thru Hub		Diameter Bolt Holes	Dia of Holes	Number of Bolt Holes	Weight (LBS)		
		Weld Neck	Slip On	Blind				WN	SO				WN	SO	Blind
	O				R	X	Y	Y							
26	31.50	1.38	1.38	1.78	29.00	27.63	26.25	3.38	2.75	29.88	0.88	28	120	105	405
28	33.50	1.38	1.38	2.00	31.00	29.63	28.25	3.38	2.75	31.88	0.88	28	130	115	490
30	35.50	1.38	1.38	2.13	33.25	31.88	30.25	3.63	2.75	34.13	0.88	36	150	130	590
32	37.75	1.38	1.38	2.25	35.25	33.88	32.25	3.63	2.75	36.13	0.88	36	160	140	700
34	40.25	1.50	1.75	2.38	37.38	35.88	34.25	3.75	3.38	38.38	1.00	36	195	200	80
36	42.25	1.50	1.75	0.50	39.38	37.88	36.25	3.75	3.38	40.38	1.00	36	205	210	970
38	44.25	1.75	2.00	2.63	41.38	39.88	38.25	4.13	3.75	42.38	1.00	36	245	250	1125
40	46.25	1.75	2.00	2.75	43.38	41.88	40.25	4.13	4.00	44.38	1.00	40	255	270	1300
42	49.00	2.00	2.38	2.88	45.75	44.13	42.25	4.50	4.38	46.88	1.13	40	340	365	1500
44	51.00	2.00	2.38	3.00	47.75	46.13	44.25	4.50	4.38	48.88	1.13	40	360	380	1700
46	53.00	2.00	2.38	3.13	49.75	48.13	46.25	4.50	4.63	50.88	1.13	40	375	410	1925
48	55.00	2.25	2.63	3.38	51.75	50.13	48.25	4.88	4.88	52.88	1.13	44	430	460	2225
50	57.00	2.25	2.63	3.38	53.75	52.13	50.25	4.88	4.88	54.88	1.13	44	450	480	2400
52	59.50	2.63	3.00	3.63	56.00	54.25	52.25	5.38	5.38	57.25	1.25	44	560	600	2800
54	61.50	2.63	3.00	3.63	58.00	56.25	54.25	5.38	5.38	59.25	1.25	44	580	620	3000
60	67.50	2.75	3.13	4.00	64.00	62.25	60.25	5.75	5.88	65.25	1.25	48	680	730	4000
66	73.50	3.13	4.00	4.38	70.00	68.50	66.25	6.13	6.88	71.25	1.25	56	830	1000	5175
72	80.00	3.63	5.00	4.75	76.50	74.50	72.25	6.63	8.00	77.75	1.25	64	1075	1400	6650

1. All dimensions are in inches
2. Can be furnished with flat face

3. Customer to specify bore dimension
4. Customer to specify hub diameter at bevel

Flanges up to 260" diameter can be shipped direct from factory

Sumitec Int'l, Inc

Website: <http://www.sumitec.com>

Phone (877) 837-9618 Fax (866) 311-5335 email:sales@sumitec.com