

# INDUSTRY STANDARD CLASS 250 WN & SLIP-ON FLANGES

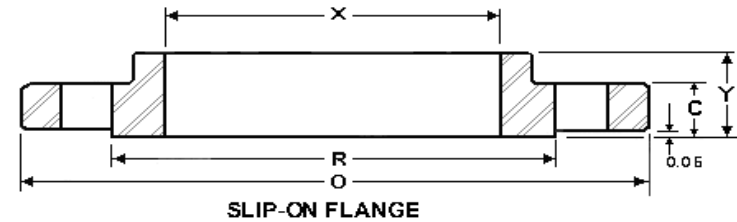
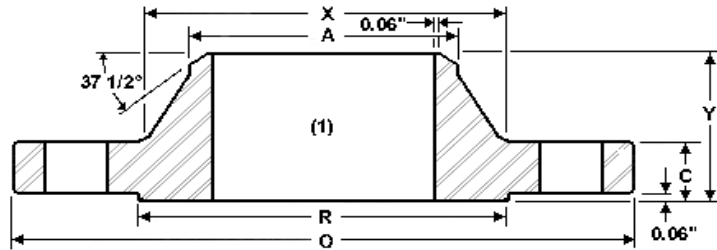

Nominal Size	Outside Diameter (O)	Inside Diameter Slip-On	Thickness (C)	Length Thru. Hub		Hub Diameter (X)	Number of Bolt Holes	Diameter Of Bolt Holes	Diam.of Bolt Circle	Weight (LBS)	
				WN (Y)	SO (Y)					WN	Slip-On
26	38.25	26.25	2.81	5.81	4.75	30.50	28	1.88	34.50	534	531
28	40.75	28.25	2.94	5.94	5.00	33.00	28	1.88	37.00	629	637
30	43.00	30.25	3.00	6.00	5.00	35.25	28	1.88	39.25	702	707
32	45.25	32.25	3.12	6.12	5.12	37.50	28	1.88	41.50	793	801
34	47.50	34.25	3.25	6.25	5.25	39.50	28	1.88	43.50	882	889
36	50.00	36.25	3.38	6.38	5.38	41.50	32	2.13	46.00	969	970
38	52.25	38.25	3.44	6.44	5.50	43.50	32	2.13	48.00	1057	1062
40	54.25	40.25	3.56	6.56	5.50	45.75	36	2.13	50.25	1158	1172
42	57.00	42.25	3.69	6.94	5.62	47.75	36	2.13	52.75	1318	1288
44	59.25	44.25	3.75	7.00	5.75	49.75	36	2.13	55.00	1423	1397
46	61.50	46.25	3.88	7.12	5.88	51.75	40	2.13	57.25	1536	1510
48	65.00	48.25	4.00	7.25	6.00	54.00	40	2.13	60.75	1824	1797

1. All dimensions are in inches
2. Drilling template per ANSI B16.1

3. Purchaser to specify the bore of Weldneck Flanges.
4. Can also be supplied with flat face

Flanges up to 260" diameter can be shipped direct from factory

## Sumitec Int'l, Inc

Website: <http://www.sumitec.com>

Phone (877) 837-9618 Fax (866) 311-5335 email: [sales@sumitec.com](mailto:sales@sumitec.com)